

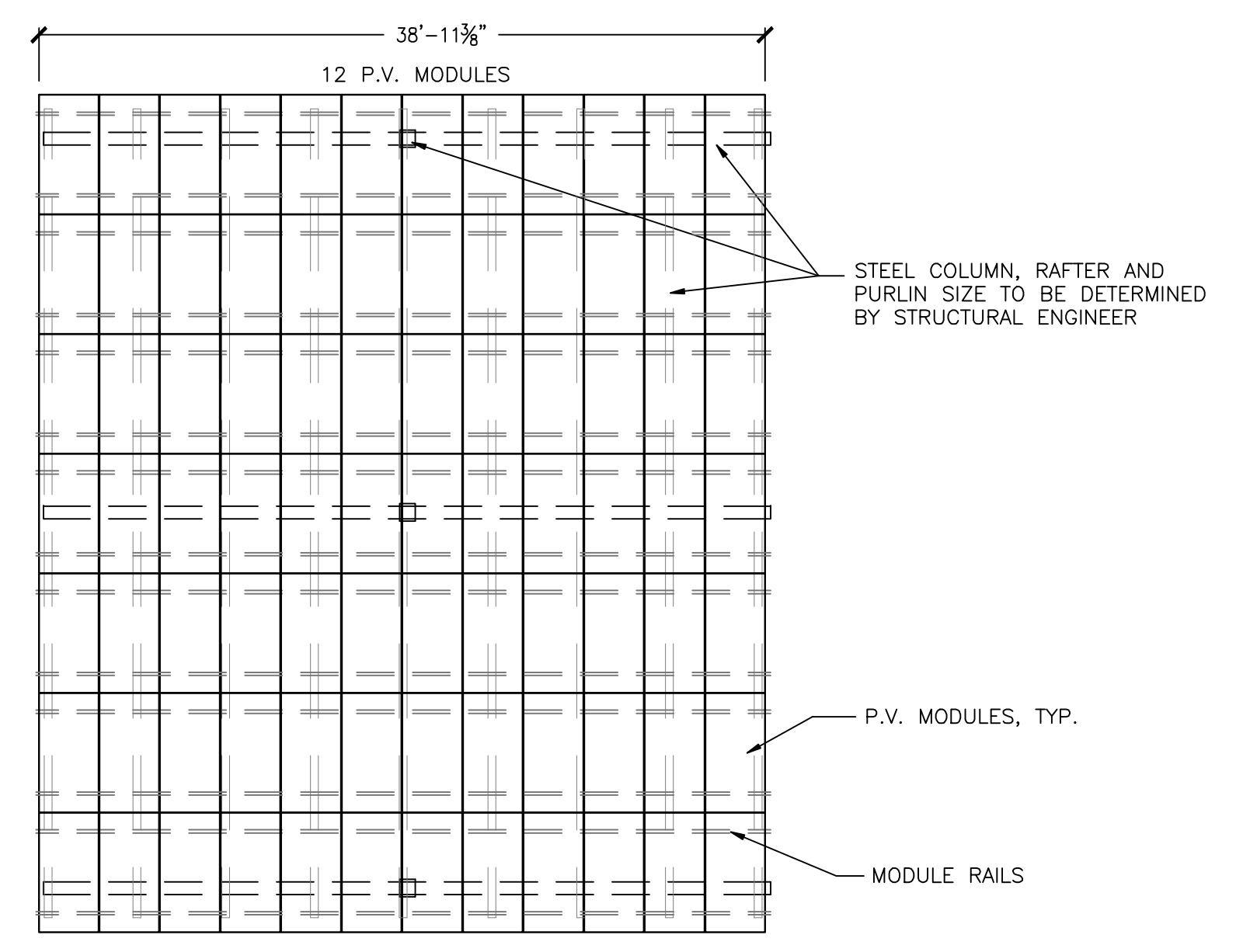

**1 F1** TANDEM "T" - CARPORT DESIGN  
NTS

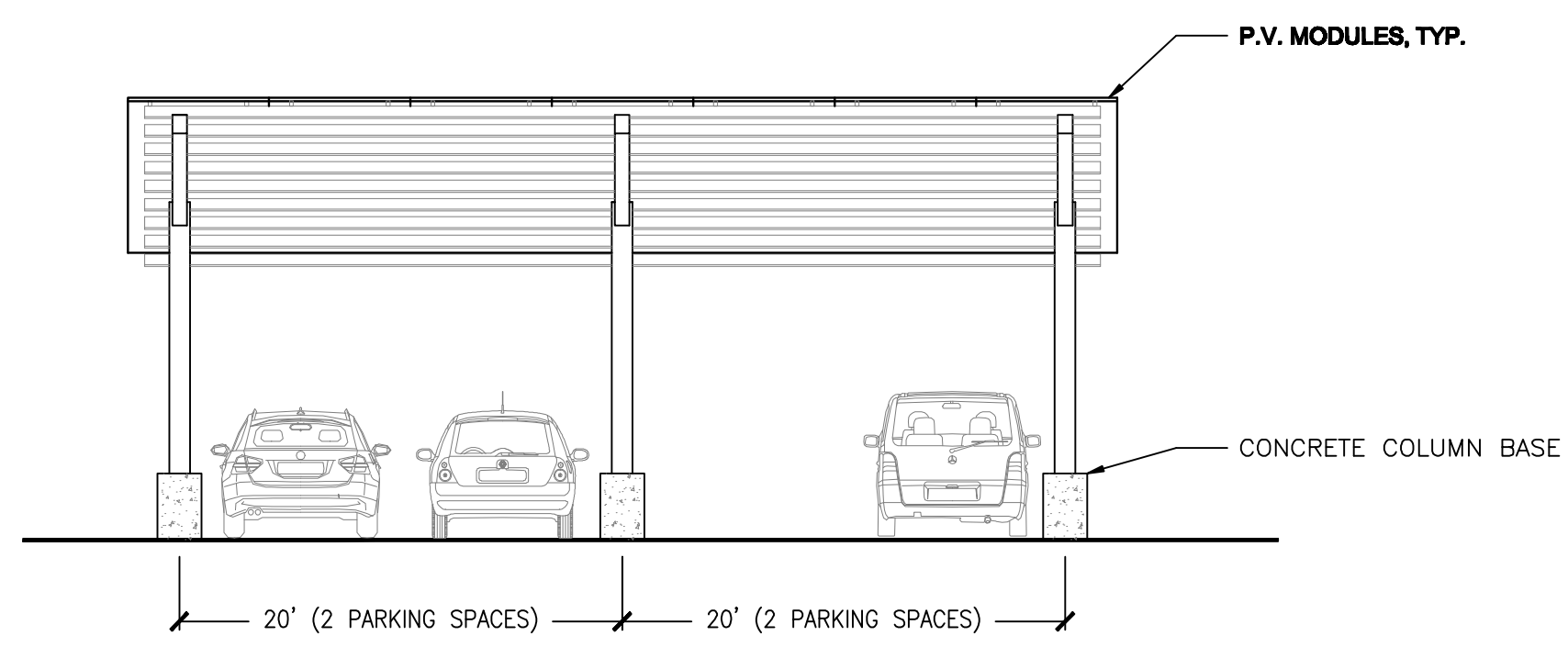

**1A F1** PLAN VIEW  
SCALE: 1/8" = 1'-0"

**1B F1** REAR ELEVATION  
SCALE: 1/8" = 1'-0"

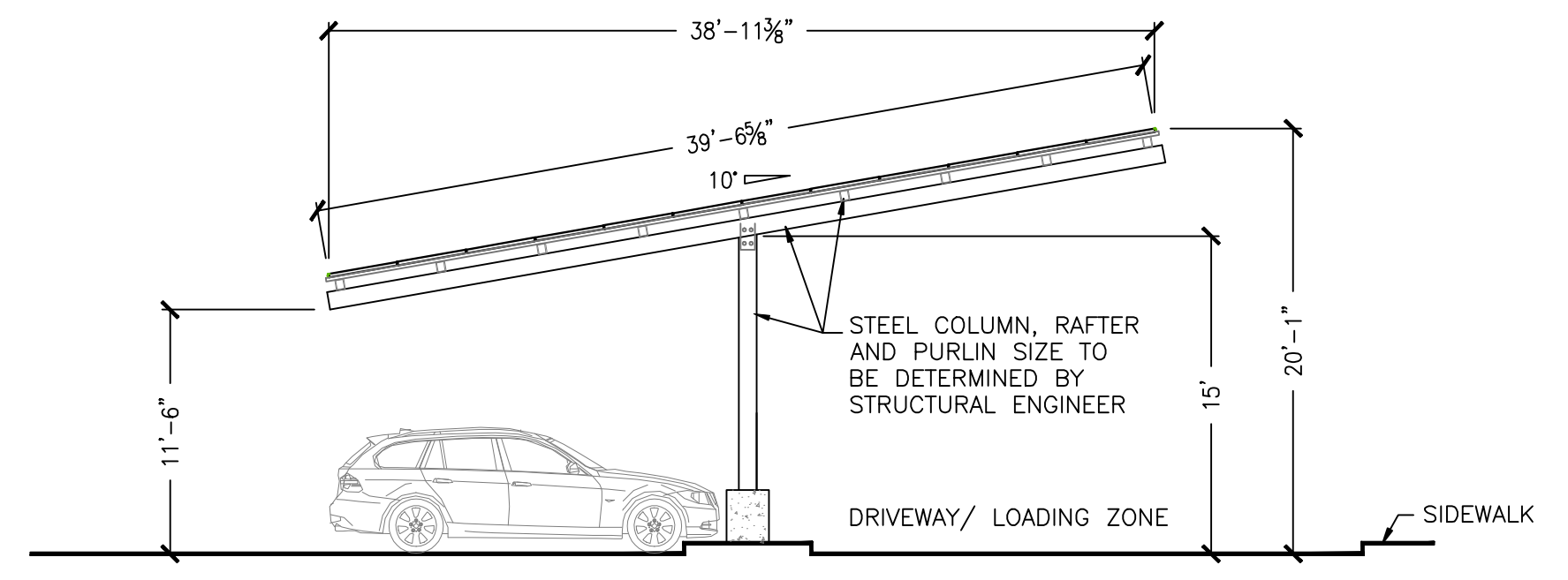
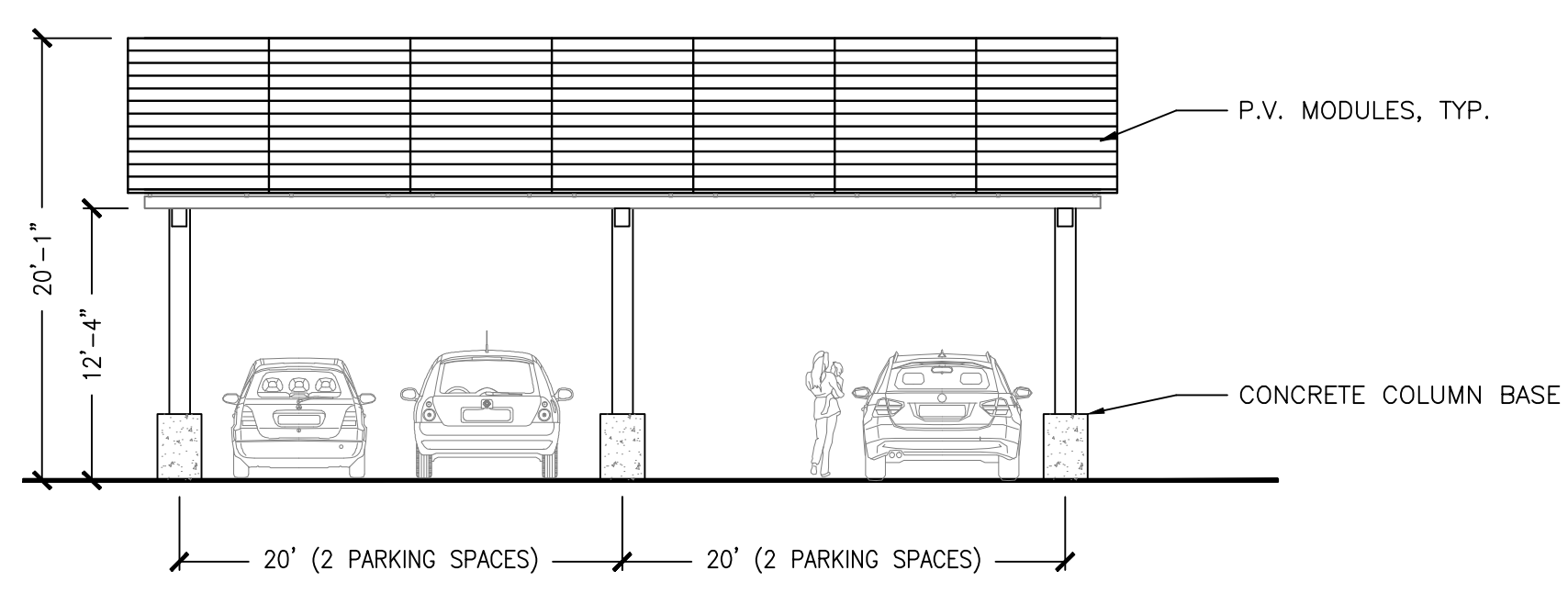

**1D F1** SECTION VIEW  
SCALE: 1/8" = 1'-0"

**1C F1** FRONT ELEVATION  
SCALE: 1/8" = 1'-0"

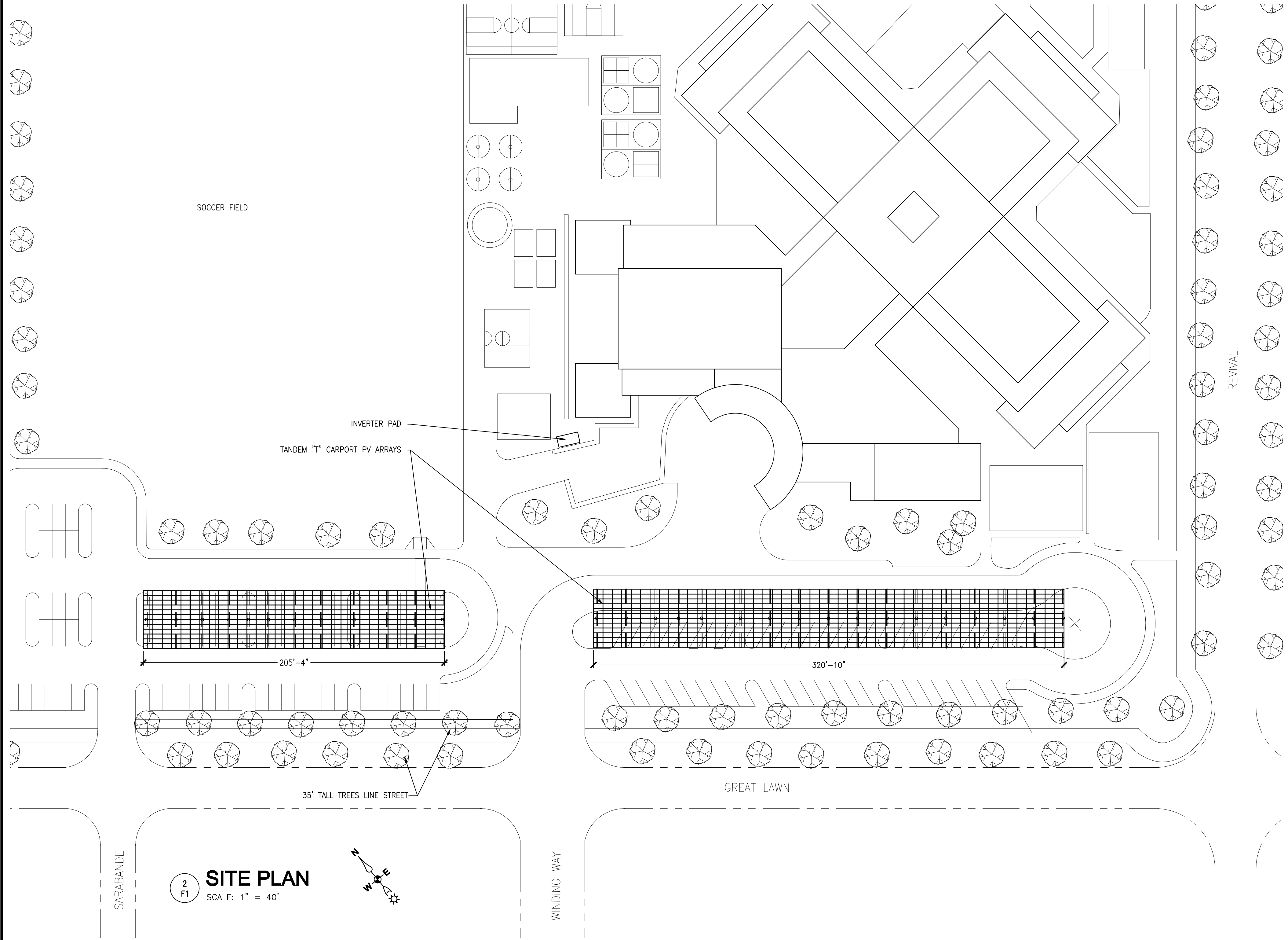

**2 F1** SITE PLAN  
SCALE: 1" = 40'

**SPG SOLAR**  
PROPERTY OF SPG SOLAR, INC.  
EXPRESS WRITTEN PERMISSION OF A DULY AUTHORIZED REPRESENTATIVE OF SPG SOLAR, INC. ALL RIGHTS RESERVED. OTHER INFORMATION CONTAINED HEREIN ARE CONSIDERED AS CONFIDENTIAL. THIS DRAWING AND ANY DATA, DESCRIPTION, AND OR USES, IN WHOLE OR IN PART, FOR ANY PURPOSES WITHOUT THE PROPRIETARY AND THE EXCLUSIVE PROPERTY OF SPG SOLAR, INC. AND SHALL NOT BE PUBLISHED, REPRODUCED, COPIED, DISCLOSED.

20 LEVERONI COURT  
NOVATO, CA 94949  
CA LIC. #756096  
(415) 383-7857  
(415) 382-2180 FAX

**Design Acceptance:**  
By signing below, Customer hereby acknowledges approval and acceptance of the PV system as designed herein by SPG Solar, Inc.

Date: \_\_\_\_\_  
Customer Signature \_\_\_\_\_  
Print Name \_\_\_\_\_

**IUSD**  
**WOODBURY ELEMENTARY SCHOOL**  
125 GREAT LAWN  
IRVINE, CA 92620

**DESIGNER:**  
DANIEL MEYER  
**PROJECT MANAGER:**  
DOUG OSBORN  
**CONSTRUCTION:**  
TIM CHRISTMAN  
**PROJECT PHASE:**  
COMMUNITY REVIEW  
**DATE:**  
04.23.2010

(949) 936-5305  
IUSD DISTRICT MAINTENANCE OFFICE  
100 NIGHTMIST  
IRVINE, CA 92618

**SHEET TITLE:**  
CARPORT ELEVATIONS AND ARRAY LAYOUT

**SHEET NUMBER:**  
F1